

UNITED STATES DEPARTMENT OF THE INTERIOR
NATIONAL PARK SERVICE

FOR NPS USE ONLY
RECEIVED SEP 5 1978
DATE ENTERED APR 3 1979

**NATIONAL REGISTER OF HISTORIC PLACES
INVENTORY -- NOMINATION FORM**

SEE INSTRUCTIONS IN HOW TO COMPLETE NATIONAL REGISTER FORMS
TYPE ALL ENTRIES -- COMPLETE APPLICABLE SECTIONS

1 NAME

HISTORIC Old Town Brunswick

AND/OR COMMON Brunswick Old Town Historic District

LOCATION

Bounded (with minor exceptions, as noted in Section 10) by First Street to the south, Bay and New Bay Streets to the west, H Street to the north, and Cochran Street to the east.

STREET & NUMBER

CITY, TOWN

Brunswick

STATE

Georgia

VICINITY OF

CODE 13

NOT FOR PUBLICATION

CONGRESSIONAL DISTRICT

1st - Bo Ginn

COUNTY

Glynn

CODE

127

CLASSIFICATION

CATEGORY

DISTRICT

BUILDING(S)

STRUCTURE

SITE

OBJECT

OWNERSHIP

PUBLIC

PRIVATE

BOTH

PUBLIC ACQUISITION

IN PROCESS

BEING CONSIDERED

STATUS

OCCUPIED

UNOCCUPIED

WORK IN PROGRESS

ACCESSIBLE

YES: RESTRICTED

YES: UNRESTRICTED

NO

PRESENT USE

AGRICULTURE

COMMERCIAL

EDUCATIONAL

ENTERTAINMENT

GOVERNMENT

INDUSTRIAL

MILITARY

MUSEUM

PARK

PRIVATE RESIDENCE

RELIGIOUS

SCIENTIFIC

TRANSPORTATION

OTHER:

OWNER OF PROPERTY

NAME Multiple Owners

STREET & NUMBER

CITY, TOWN

Brunswick

VICINITY OF

STATE Georgia

LOCATION OF LEGAL DESCRIPTION

COURTHOUSE, REGISTRY OF DEEDS, ETC.

Glynn County Courthouse

STREET & NUMBER

G Street at Union

CITY, TOWN

Brunswick

STATE Georgia

6 REPRESENTATION IN EXISTING SURVEYS

TITLE Department of Natural Resources Survey by Van Jones Martin

DATE 1975

FEDERAL STATE COUNTY LOCAL

DEPOSITORY FOR SURVEY RECORDS

Historic Preservation Section

CITY, TOWN

Atlanta

STATE Georgia

9

7 DESCRIPTION

CONDITION		CHECK ONE	CHECK ONE
<input type="checkbox"/> EXCELLENT	<input type="checkbox"/> DETERIORATED	<input type="checkbox"/> UNALTERED	<input checked="" type="checkbox"/> ORIGINAL SITE
<input checked="" type="checkbox"/> GOOD	<input type="checkbox"/> RUINS	<input checked="" type="checkbox"/> ALTERED	<input type="checkbox"/> MOVED DATE _____
<input type="checkbox"/> FAIR	<input type="checkbox"/> UNEXPOSED		

DESCRIBE THE PRESENT AND ORIGINAL (IF KNOWN) PHYSICAL APPEARANCE

"The City of Brunswick was laid out in 1771. It consisted of a rectangular tract of land, 383½ acres, bounded on the North by F Street, on the East by Cochran Avenue, on the South by First Avenue, and on the West by the Brunswick River. Petitioners for lots bound themselves to build 'a good and sufficient dwelling house not less than 30 foot in length and 18 foot wide with a good brick chimney thereto'; otherwise the property would 'revert to his majesty, his heirs and successors."

This original plan of Brunswick became known as "Old Town". Added to this acreage by 1837 was additional land known as "New Town" which contained a large open park, now the site of the Glynn County Courthouse. At F Street, Reynolds became "B" Street, Union Street became "C" Street, Ellis Street became "D" Street and Norwich Street became "E" Street and so on on the early maps. Magnolia Park, then the city cow pasture, interrupted Union Street at "G" Street. The lands beyond Wolf Street were reserved for the town common, preserved for the use and benefit of the citizens of the City of Brunswick. These lands were leased to various citizens for agricultural purposes.

The Old Town Brunswick Historic District boundaries correspond in general to the old plan boundaries and extend northward to H Street to include Magnolia Park, the courthouse, and some residences of New Town. The boundaries of the district are, approximately, First Street on the south, Bay and New Bay Streets on the west, H Street on the north and Cochran Street on the east, totalling some 12 blocks between First and H Streets and some 12 to 13 blocks between the Bay Streets and Cochran Street.

A portion of this area along Bay Street has already been listed on the National Register as an Archaeological site. Under Urban Renewal in 1974 this three by seven block strip was leveled and is as yet largely undeveloped. It is included here again because of the significance of the Brunswick Plan which remains intact today including the original Colonial street names.

The streets form a regular north-south grid pattern. The plan is remarkably similar to that of Savannah, being divided into wards and squares. Two rows of 5 wards each extend eastward from the Bay. As in the Savannah Plan several streets between wards are divided avenues, specifically Union and Albany Streets.

The early 19th Century appearance of Brunswick is described in Bay Street Urban Renewal Area Archaeological District Nomination. This present nomination will describe the post Civil War building period, a time of significant expansion for the City of Brunswick.

Today, the Old Town Brunswick Historic District is characterized by shaded, tree-lined streets, hexagonal patent paving stones, and picturesque houses situated on spacious landscaped lots.

The residential architecture is primarily of frame construction, one or two stories high, ornamented with porches, brackets, and scroll saw work, much of it manufactured in Brunswick. The styles range from simple cottage tenements (718 Carpenter Street) and shotgun cottages (1210-1214 Reynolds Street, 1400 block Prince Street), to two story frame houses which turn their gable end to the street (1024



UNITED STATES DEPARTMENT OF THE INTERIOR
NATIONAL PARK SERVICE

**NATIONAL REGISTER OF HISTORIC PLACES
INVENTORY -- NOMINATION FORM**

FOR NPS USE ONLY	
RECEIVED	SEP 5 1978
DATE ENTERED	APR 3 1979

CONTINUATION SHEET Description ITEM NUMBER 7 PAGE 2

Union Street). The larger houses are frequently in the Queen Anne style (905 Union Street) or stick style (502 London Street) with multiple gables, turrets, and a variety of textures ornamenting the facades. Several of the more substantial houses along Union Street and on the Trust Lots facing the Squares are constructed in brick, some with tile roofs popular in the 1920's (815 Union Street). A few are in the Edwardian style of the World War I years and a few mansard roofs (Hanover Square) are scattered about the District. Revival styles are evident in the church edifices, notably the Gothic of St. Mark's Episcopal Church and the Moorish of the Temple Beth Tefilloh.

Brunswick contains a significant number of small houses which are important as blocks such as those in the 1000 block of Albany Street or the 1100 block of Ellis Street, and the 900 block of Richmond. Brunswick also has a number of corner stores, a rapidly disappearing feature of most towns, which enhance the neighborhood quality of the Historic District. Some are located at the corner of Prince and Cochran and the corner of George and Amherst.

In 1885, Brunswick suffered a devastating fire in its commercial district. This area had also been the frequent victim of flooding; Mansfield Street and H Street were nothing more than tidal inlets. In 1887, New Castle Street from F to George Street and Grant Street from Mansfield to George were raised. New construction flourished at this time as well as an interest in tabby as a fireproof building material. The Sanborn Maps show a prodigious number of structures constructed in tabby at this time. St. Athanasius Church at Albany and Monck Streets is a tabby structure.

The original plan is interrupted by two housing projects, which, while giving no sense of neighborhood, generally follow the old street patterns, and by the academy site. The riverfront buildings were lost under Urban Renewal, but by and large the character of old Town Brunswick has been retained. Commercial activities are generally confined to Gloucester and New Castle Streets. The old residential streets are lined with quaint gingerbread houses, many of which are in the process of being restored. There is an active interest in preservation in Brunswick.

Only one of the squares remains unaltered; but, of the remainder, all but Hillsborough and Wright could be reclaimed as a step to strengthen the Historic District.

Elaborate carving and millwork, stained glass, novel scroll saw work add interest and variety to a district that speaks to the tremendous growth of Brunswick during the lumber years. With Brunswick still a major port city expanding miles beyond the Old Town area, the Old Town Historic District becomes a critical focal point for conservation as a neighborhood where all residents can live and work without displacement. It should and can be restored to its former magnificence.

35

8 SIGNIFICANCE

PERIOD		AREAS OF SIGNIFICANCE -- CHECK AND JUSTIFY BELOW			
<input type="checkbox"/> PREHISTORIC	<input type="checkbox"/> ARCHEOLOGY-PREHISTORIC	<input checked="" type="checkbox"/> COMMUNITY PLANNING	<input checked="" type="checkbox"/> LANDSCAPE ARCHITECTURE	<input type="checkbox"/> RELIGION	
<input type="checkbox"/> 1400-1499	<input type="checkbox"/> ARCHEOLOGY-HISTORIC	<input type="checkbox"/> CONSERVATION	<input type="checkbox"/> LAW	<input type="checkbox"/> SCIENCE	
<input type="checkbox"/> 1500-1599	<input type="checkbox"/> AGRICULTURE	<input type="checkbox"/> ECONOMICS	<input type="checkbox"/> LITERATURE	<input type="checkbox"/> SCULPTURE	
<input type="checkbox"/> 1600-1699	<input checked="" type="checkbox"/> ARCHITECTURE	<input type="checkbox"/> EDUCATION	<input type="checkbox"/> MILITARY	<input type="checkbox"/> SOCIAL/HUMANITARIAN	
<input checked="" type="checkbox"/> 1700-1799	<input type="checkbox"/> ART	<input type="checkbox"/> ENGINEERING	<input type="checkbox"/> MUSIC	<input type="checkbox"/> THEATER	
<input checked="" type="checkbox"/> 1800-1899	<input type="checkbox"/> COMMERCE	<input type="checkbox"/> EXPLORATION/SETTLEMENT	<input type="checkbox"/> PHILOSOPHY	<input checked="" type="checkbox"/> TRANSPORTATION	
<input type="checkbox"/> 1900-	<input type="checkbox"/> COMMUNICATIONS	<input checked="" type="checkbox"/> INDUSTRY	<input type="checkbox"/> POLITICS/GOVERNMENT	<input checked="" type="checkbox"/> OTHER (SPECIFY) Preservation	
		<input type="checkbox"/> INVENTION			

SPECIFIC DATES 1771, late 19th C.

BUILDER/ARCHITECT

STATEMENT OF SIGNIFICANCE

The Old Town Brunswick Historic District is significant in that it retains its original town plan as well as an outstanding collection of late 19th century residential and public structures. The laying out of the plan was reportedly superintended by Governor Wright who was still in residence in Savannah in 1771. It is remarkably similar to the Savannah plan, being laid out in Wards with house and trust lots surrounding central squares in each ward. The larger squares were named Hillsborough, Wright, Halifax, Queen, Hanover, and King. Hanover is the only square to remain unaltered today, although several others, bisected by streets at various times, could be reclaimed as their sections are free from development. Only Hillsborough has been completely lost.

The plan deviates slightly from the Savannah plan in that there are 8 smaller parks laid out between Carpenter and Egmont Streets, Richmond and Grant Streets on the northern and southern ends of the District. These exist today as open spaces.

Brunswick and Savannah were and still are the two major deep water ports on the coast of Georgia. In the 1870's the town was stacked with lumber and skids (the timber framework used as a track for sliding the heavy lumber) and trains ran down both Cochran and Bay announcing a new prosperous merchantile era for the city. Brunswick was awakening from her slumbers that had extended through the years preceding and following the Civil War. With the development of a South Atlantic Coast Railroad system extending from the deep water ports to the inland, Brunswick was to grow and prosper. With this growth was also the promotion of Brunswick and the Golden Isles as a "charming Winter resort," which attracted Northern interest in this marshy southern port.

Brunswick boasted a population of 5,000 in 1885, but her buildings were mostly frame, seldom grander than mere shanties. Mansfield street was a tidal ditch, but that year marked the beginning of a great building boom. NewCastle street had been burned in a fire and merchants were rapidly proceeding to construct new durable brick and tabby buildings. The population doubled in three years to 10,000 in 1888. Building and Loan Associations like the Mechanics Building and Loan Association enabled residents to push forward new structures and promoters boasted "massive brick buildings, balmy pines, fragrant magnolias, commodious streetcars, and unrivalled boulevards."

Public improvements such as efforts to pave the streets and sidewalks, the introduction of the street railroad, and the establishment of the Brunswick Gas and Electric Company in the 1880's, and the lighting of the streets with gas, accelerated the development of Brunswick. The building boom after the fire and the advertising of the salubrious climate attracted the interest of out-of-town architects

(11)

9 MAJOR BIBLIOGRAPHICAL REFERENCES

Mrs. Albrecht Reu, Mrs. Nathan Atkinson Brown, editors, The Streets and Squares of Olde Brunswick, 1975, Brunswick Chapter, Daughters of the American Revolution.
 Sanborn Maps of Brunswick, 1885, 1889, 1893, 1908, 1913, University of Georgia Science Library
 Minutes of City Council, various years from 1856 on. Brunswick City Hall
 City Ordinance Books, Brunswick City Hall

10 GEOGRAPHICAL DATA

ACREAGE OF NOMINATED PROPERTY approximately 399 acres

UTM REFERENCES Quadrangle Name: Brunswick East Scale: 1:24000

DA	1,7	4,5,2	4,3,0	3,4	4,6	4,6,0	AR	1,7	4,5,3	3,1,0	3,4	4,6	7,3,0
	ZONE	EASTING		NORTHING				ZONE	EASTING		NORTHING		
BE	1,7	4,5,3	9,0,0	3,4	4,4	8,0,0	CR	1,7	4,5,3	0,2,0	3,4	4,4	5,4,0

VERBAL BOUNDARY DESCRIPTION

The Brunswick Old Town Historic District is bounded by the north side of First Street on the south, the east side of Bay and New Bay Streets on the west, the south side of H Street on the north, and the west side of Cochran Street to the east; except that the district also includes the property and grounds of the Old Brunswick Hospital (now the Coastal Georgia Area Action Authority building) at 523 Norwich Street and that of the houses at 527 and 528 Union Street, 508 First Street, and 520 New Castle Street, adjacent to the aforementioned south boundary, and the property and grounds of the (cont)

LIST ALL STATES AND COUNTIES FOR PROPERTIES OVERLAPPING STATE OR COUNTY BOUNDARIES

STATE	CODE	COUNTY	CODE
STATE	CODE	COUNTY	CODE

11 FORM PREPARED BY

NAME / TITLE Beth Lattimore Reiter, Historic Preservation Planner; Richard Cloues, Architectural Historian, Historic Preservation Section

ORGANIZATION	DATE
Historic Preservation Section	August 25, 1978
STREET & NUMBER	TELEPHONE
270 Washington Street, S. W.	404/256-2840
CITY OR TOWN	STATE
Atlanta	Georgia 30334

12 STATE HISTORIC PRESERVATION OFFICER CERTIFICATION

THE EVALUATED SIGNIFICANCE OF THIS PROPERTY WITHIN THE STATE IS:

NATIONAL STATE LOCAL

As the designated State Historic Preservation Officer for the National Historic Preservation Act of 1966 (Public Law 89-665), I hereby nominate this property for inclusion in the National Register and certify that it has been evaluated according to the criteria and procedures set forth by the National Park Service.

STATE HISTORIC PRESERVATION OFFICER SIGNATURE Elizabeth A. Lyon
 TITLE State Historic Preservation Officer DATE 8/28/78

FOR NPS USE ONLY

I HEREBY CERTIFY THAT THIS PROPERTY IS INCLUDED IN THE NATIONAL REGISTER

ATTEST: William J. Labadie DATE 9/2/78
 DIRECTOR, OFFICE OF ARCHEOLOGY AND HISTORIC PRESERVATION
 KEEPER OF THE NATIONAL REGISTER

DATE April 2, 1979

UNITED STATES DEPARTMENT OF THE INTERIOR
NATIONAL PARK SERVICE

**NATIONAL REGISTER OF HISTORIC PLACES
INVENTORY -- NOMINATION FORM**

FOR NPS USE ONLY	
RECEIVED	SEP 5 1978
DATE ENTERED	APR 3 1979

CONTINUATION SHEET Significance ITEM NUMBER 8 PAGE 2

and builders. James R. Ryan, one such man attracted by the building opportunity and climate, stayed to construct many of the early commercial buildings such as the Crovatt, Wright and Burchardt buildings erected following the fire in 1885. Vestiges of this commercial rejuvenation still exist on New Castle Street in buildings like the Elliot Building. Many of the two and three story brick and tabby commercial buildings are ornamented with cast iron cornices and window lintels (1300 and 1400 blocks of New Castle).

The 1892 City Directory lists 15 contractors and builders and 83 carpenters. Outstanding architects erected outstanding buildings. A. S. Eichberg was born in New York City in 1859, the son of a plumber and gas fitter. His family moved to Atlanta in the 1860's. Eichberg studied to be an architect and formed a firm with Calvin Fay, who had come to Savannah to superintend the building of St. John's Episcopal Church for Ohio architect Calvin Otis. Eichberg worked in Atlanta and soon opened an office in Savannah. His residential work in the Queen Anne style in Savannah is outstanding, reaching its peak perhaps in the Wood house on Whitaker Street and in 118 West Hall Street.

A. S. Eichberg was already a known figure in Brunswick in 1889 when he maintained that year both a Savannah and a Brunswick architectural office. His Brunswick office was located on New Castle Street. As in Savannah, his work in Brunswick was principally in the Queen Anne style. One of his most notable works in Brunswick is the Old City Hall, located in a corner of Queen Square. Designed in 1889, the Old City Hall stands two stories high with a high attic. The ground story is faced with rough cut granite stone. An octagonal three story tower stands to the right of the arched stone entrance with a round tower on the left. The structure is richly ornamented with terracotta and stone decorations. Eichberg's building for the Glynn Academy was noted at the time for its fireproof divisions (the school is built in three sections) and for its lighting arrangements in which each classroom is well-lighted from two sides. The newspapers, at the time of the publication of the school plans, announced that Eichberg was an architect "whose skill is recognized in this City." No doubt it will be discovered that many of the fine Queen Anne style residences of Brunswick are from his pen.

Another notable architect working in Brunswick in the late nineteenth century was J. A. Wood. He was practicing in New York in the 1870's and seems first to appear in the Savannah area in 1884, when he submitted plans for a hotel to be built where the present DeSoto Hotel now stands. It appears that Mr. Wood took advantage of the expanding railroad systems of men like Plant, by developing resort hotels along their routes. He was responsible for the Piney Woods Hotel and the Mitchell House in Thomasville, Georgia. His work in Savannah was significant and included the old Guard's Armory, destroyed by fire shortly after it was built, and a four story, iron front retail building for A. R. Altmeyer, similar in plan to Lord and Taylor's in New York City. Unfortunately, this too was destroyed by fire in the 1950's.

36

UNITED STATES DEPARTMENT OF THE INTERIOR
NATIONAL PARK SERVICE

**NATIONAL REGISTER OF HISTORIC PLACES
INVENTORY -- NOMINATION FORM**

FOR NPS USE ONLY	
RECEIVED	SEP 5 1978
DATE ENTERED	APR 3 1979

CONTINUATION SHEET Significance ITEM NUMBER 8 PAGE 3

In Brunswick, Mr. Wood is attributed with designing the Mahoney House and the Oglethorpe Hotel, two of the most significant structures to be built in the Brunswick District. The Mahoney House still stands in excellent condition with elaborate plaster medallions and sawn woodwork; however, the Oglethorpe Hotel has been demolished. Wood was still practicing as late as 1894 in New York City.

With all the construction activity, it naturally followed that local manufacturing firms would be developed, like that of Moore and Valentino. From their planing mill and shops on New Castle Street, they manufactured mouldings and newell posts, brackets, sashes and windows that adorn the houses of Brunswick. In 1888, they announced that they would be available as contractors and builders as well. In 1890, similar establishments included A. Hughes, Boone and Company, who also manufactured sashes, doors and blinds locally.

In 1908, incandescent lights eclipsed the old gas lights; and the City Council was wrestling with laying out a consistent course for automobile traffic along Union Street. The sidewalks were being paved in hexagonal patent stone tiles, and the street railroads were carrying people to new neighborhoods north of Magnolia Park to live.

Today, the Old Town Historic District is a multi-purpose District where residential, commercial and professional activities are carried on along broad oak-lined avenues. The inhabitant is never far from a green park which, as in Savannah, slows traffic down to an acceptable pace. As in Savannah, so too is Brunswick a walking city. There is a broad mix of people living in the Historic District. Whether in magnificent Victorian gingerbread mansions or simple shotgun cottages, these residents of all income levels are within walking distance of jobs and services. Also as in Savannah, aesthetics and open space are available to all residents.

UNITED STATES DEPARTMENT OF THE INTERIOR
NATIONAL PARK SERVICE

**NATIONAL REGISTER OF HISTORIC PLACES
INVENTORY -- NOMINATION FORM**

FOR NPS USE ONLY	
RECEIVED	3/27/79
DATE ENTERED	APR 3 1979

CONTINUATION SHEET

ITEM NUMBER

PAGE

SUPPLEMENT

BRUNSWICK OLD TOWN HISTORIC DISTRICT
BRUNSWICK, GLYNN COUNTY, GEORGIA

Photographs

Additional photographs of the proposed Brunswick Old Town Historic District have been provided by the City of Brunswick; these photographs were produced by an independent consultant in the city. These additional district photographs, like those included with the original nomination form, are representative of the character and appearance of the proposed historic district. Taken together, all the photographs convey a faithful representation of the district as a whole and of its component parts.

Description and Evaluation of "Infill"

Architecturally and historically significant buildings and grounds are described in the text of the nomination, inventoried on continuation sheets, and marked on the district sketch map. Intrusions and other non-contributing properties are likewise described, inventoried, and mapped. All other properties in the historic district can be considered as "infill" which, although not outstanding in and of itself, contributes nevertheless to the overall character and appearance of the area. This infill constitutes the setting for the more important properties; it completes streetscapes, defines blocks, and provides enclosure of public spaces.

Description of Sub-Areas Within District

In terms of architecture and use, there are two principal subdivisions within the proposed Brunswick Old Town Historic District: commercial and residential. Commercial architecture and uses are concentrated in the northwest sector of the city; commercial uses also stretch across the entire northern end of the district. Gloucester Street, running east-west, and New Castle Street, running north-south, are the principal commercial cross-axes. At their intersection, and along New Castle Street, are found mostly two to three story, late nineteenth to early twentieth century, brick buildings. Further east, commercial uses are frequently

UNITED STATES DEPARTMENT OF THE INTERIOR
NATIONAL PARK SERVICE

**NATIONAL REGISTER OF HISTORIC PLACES
INVENTORY -- NOMINATION FORM**

FOR NPS USE ONLY	
RECEIVED	3/27/79
DATE ENTERED	APR 3 1979

CONTINUATION SHEET Supplement ITEM NUMBER PAGE 2

housed in originally residential structures. Residential architecture of various types is spread through the district rather than organized by sectors or even streets. For example, fronting on Reynolds Street are both Victorian mansions and shotgun houses. In general, however, the more substantial Victorian, turn-of-the-century, and early twentieth century houses are found along principal streets such as Union, New Castle, and Reynolds in the south half of the district, and the more modest cottages and shotguns are found along the eastern edge of the district. The various landscaped squares are generally the settings for the most elaborate residential architecture. The oldest houses in the district tend to survive near the waterfront in areas that have largely redeveloped since the early nineteenth century. Churches and corner stores are scattered throughout the district. Intrusions are for the most part concentrated in the commercial area.

Relation to Bay Street Urban Renewal Area

Boundaries of the proposed Brunswick Old Town Historic District and the previously registered Bay Street Urban Renewal Area overlap in the general vicinity of New Castle and Grant Streets between Hanover Square and H Street. The Bay Street Urban Renewal Area nomination registered an historic archaeological site. It was prepared in reaction to a federal project impacting the area. The Brunswick Old Town Historic District will register the surviving architectural and historical resources in the Old Town area. Thus, even though their boundaries overlap, the two nominations are different in methodology, content, and intent; there is little duplication of effort. Each nomination has been given a distinct common name. Both, however, have a similar historic name because both deal ultimately with the same historic resource: the Old Town of Brunswick.

Boundaries

Boundaries of the Brunswick Old Town Historic District are essentially those of the original 1771 city plan as amended in 1837. For more than a century, development in Brunswick took place within the boundaries of these plans. Because of Savannah's dominance as a port in the eighteenth and early nineteenth centuries, and because of the extensive damage to the city during the Civil War, Brunswick did

UNITED STATES DEPARTMENT OF THE INTERIOR
NATIONAL PARK SERVICE

FOR NPS USE ONLY	
RECEIVED	3/29/79
DATE ENTERED	APR 3 1979

**NATIONAL REGISTER OF HISTORIC PLACES
INVENTORY -- NOMINATION FORM**

CONTINUATION SHEET Supplement ITEM NUMBER PAGE 3

not expand significantly beyond its historic boundaries until modern times. Thus the original plan as amended bounds the most significant historic and architectural resources in the City of Brunswick.

Prepared By:

Richard Cloues
Architectural Historian
Historic Preservation Section
Department of Natural Resources
270 Washington Street, S. W.
Atlanta, Georgia 30334
404/656-2840

March 21, 1979

Elizabeth A. Lyon
Elizabeth A. Lyon, Ph.D., Chief
Historic Preservation Section
Acting State Historic Preservation Officer

3/20/79
Date

UNITED STATES DEPARTMENT OF THE INTERIOR
NATIONAL PARK SERVICE

**NATIONAL REGISTER OF HISTORIC PLACES
INVENTORY -- NOMINATION FORM**

FOR NPS USE ONLY		
RECEIVED	SEP 5 1978	
DATE ENTERED	APP 2	1070

CONTINUATION SHEET

ITEM NUMBER

PAGE

OLD TOWN BRUNSWICK, BRUNSWICK, GLYNN COUNTY
List Of Historically Significant Structures
(Locations keyed to the attached sketch map.)

<u>ADDRESS/LOCATION</u>	<u>DATE BUILT</u>	<u>ARCHITECT</u>
1. 501 G Street	Post 1898	
2. 503 G Street	Post 1898	
3. 704 G Street		
4. 706 G Street	1887-1898	
5. 708-710 G Street		
6. 800 G Street		
7. 802 G Street		
8. 803 G Street	Pre 1889	
9. 804 G Street	1889-1898	
10. 806 G Street	1889-1898	
11. 808 G Street	Pre 1889	
12. 809 G Street	Pre 1889	
13. 901 G Street		
14. 902 G Street		
15. 904 G Street		
16. 1010 G Street		
17. 1100 G Street		

UNITED STATES DEPARTMENT OF THE INTERIOR
NATIONAL PARK SERVICE

**NATIONAL REGISTER OF HISTORIC PLACES
INVENTORY -- NOMINATION FORM**

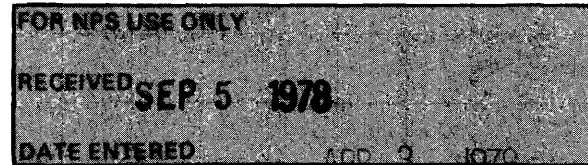

CONTINUATION SHEET

ITEM NUMBER

PAGE

2

<u>ADDRESS/LOCATION</u>	<u>DATE BUILT</u>	<u>ARCHITECT</u>
18. 1102 G Street		
19. 1104 G Street		
20. 1301 G Street		
21. Glynn County Courthouse (In square bounded by Reynolds, Ellis, G and H Streets)	1907	C.A. Gifford, E. S. Betts
22. 409 F Street		
23. 707-709 F Street		
24. 711 F Street		
25. 1203 F Street		
26. City Hall (Gloucester Street between Reynolds and Union Streets)	1902	
27. St. Mark's Church (Gloucester Street between Norwich and Egmont Streets)	1890	
28. Miller Funeral Home (Gloucester Street between Wolf and Carpenter Streets)	c. 1900	
29. 604 Monck		
30. 608 Monck	Pre 1885	
31. 803 Monck		
32. 804 Monck		
33. 805 Monck		
34. 808 Monck	1885	

180

UNITED STATES DEPARTMENT OF THE INTERIOR
NATIONAL PARK SERVICE

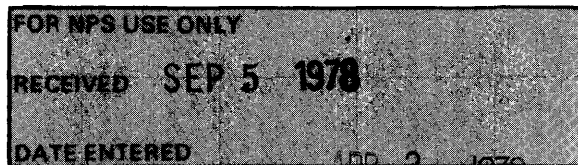

**NATIONAL REGISTER OF HISTORIC PLACES
INVENTORY -- NOMINATION FORM**

CONTINUATION SHEET

ITEM NUMBER

PAGE 3

<u>ADDRESS/LOCATION</u>	<u>DATE BUILT</u>	<u>ARCHITECT</u>
35. 809 Monck	1882	
36. 903 Monck		
37. Temple Beth Teffiloh (southeast corner of Egmont and Monck Streets)		
38. First United Methodist Church (Monck Street between Norwich and Carpenter Streets)	1905	
39. 1105 Monck		
40. 1107 Monck		
41. 1109-1111 Monck		
42. St. Athanasius Church (southwest corner of Albany and Monck Streets)		
43. 600 Mansfield	Post 1908	
44. 603 Mansfield	Pre 1893	
45. 604-608 Mansfield		
46. 1309 Mansfield		
47. 1409 Mansfield		
48. Glynn Academy Annex (Mansfield Street between Egmont and Albany Streets)	1889	A.S. Eichberg
49. Glynn Academy Building (Mansfield Street between Egmont and Albany Streets)	1905	

19

UNITED STATES DEPARTMENT OF THE INTERIOR
NATIONAL PARK SERVICE

FOR NPS USE ONLY		
RECEIVED	SEP 5	1978
DATE ENTERED	APR 3	1979

**NATIONAL REGISTER OF HISTORIC PLACES
INVENTORY -- NOMINATION FORM**

CONTINUATION SHEET

ITEM NUMBER

PAGE

4

<u>ADDRESS/LOCATION</u>	<u>DATE BUILT</u>	<u>ARCHITECT</u>
50. Glynn Academy Building, #2 (Mansfield Street between Egmont and Albany Streets)	1922	
51. 505 Howe Street		
52. 707 Howe Street		
53. 708 Howe Street	Pre 1893	
54. 709 Howe Street		
55. 803 Howe Street		
56. 805 Howe Street		
57. 807 Howe Street		
58. 809 Howe Street		
59. 206 George		
60. 503 George	Pre 1885	
61. 509 George	1898-1908	
62. 603 George		
63. 710 George		
64. 804 George		
65. 805 George		
66. 1202 George		
67. 1210 George		
68. 1302 George		
69. 1306 George		

20

UNITED STATES DEPARTMENT OF THE INTERIOR
NATIONAL PARK SERVICE

**NATIONAL REGISTER OF HISTORIC PLACES
INVENTORY -- NOMINATION FORM**

FOR NPS USE ONLY		
RECEIVED	SEP 5	1978
DATE ENTERED	APR 3	1979

CONTINUATION SHEET

ITEM NUMBER

PAGE

5

<u>ADDRESS/LOCATION</u>	<u>DATE BUILT</u>	<u>ARCHITECT</u>
70. 1308 George		
71. Store (southeast corner of Amherst and George Streets)		
72. 502 London Street		
73. 503 London Street		
74. 509 London Street		
75. 706-708 London Street		
76. 802 London Street	Pre 1908	
77. 803-801 London Street		
78. 1102 London Street	Pre 1908	
79. 1203-1205 London Street		
80. 1208 London Street		
81. 1307 London Street		
82. 1309 London Street		
83. 1311 London Street		
84. 1400 London Street		
85. 1401 London Street		
86. 501 Prince Street		
87. 507 Prince Street		
88. 509 Prince Street		
89. 600 Prince Street	Post 1908	

21

UNITED STATES DEPARTMENT OF THE INTERIOR
NATIONAL PARK SERVICE

FOR NPS USE ONLY
RECEIVED SEP 5 1978
DATE ENTERED APR 3 1979

**NATIONAL REGISTER OF HISTORIC PLACES
INVENTORY -- NOMINATION FORM**

CONTINUATION SHEET

ITEM NUMBER

PAGE

6

<u>ADDRESS/LOCATION</u>	<u>DATE BUILT</u>	<u>ARCHITECT</u>
90. 601 Prince Street	Pre 1908	
91. 711 Prince Street		
92. 1102 Prince Street	Post 1908	
93. 1110 Prince Street	Pre 1908	
94. 1111 Prince Street	Pre 1908	
95. 1200 Prince Street		
96. 1203 Prince Street	c. 1899	
97. 1207 Prince Street		
98. 1209 Prince Street		
99. 1303 Prince Street	1880's	
100. - 105. 1400 Block Prince Street (south side)		
106. Northwest Corner of Prince and Cochran		
107. 508 Albermarle Street		
108. 509 Albermarle Street		
109. 601 Albermarle Street		
110. 1103 Albermarle Street		
111. 1203 Albermarle Street	1908	
112. 205 Dartmouth Street		
113. 500 Dartmouth Street	1908	
114. 502 Darmouth Street	1908	

62

UNITED STATES DEPARTMENT OF THE INTERIOR
NATIONAL PARK SERVICE

**NATIONAL REGISTER OF HISTORIC PLACES
INVENTORY -- NOMINATION FORM**

FOR NPS USE ONLY
RECEIVED SEP 5 1978
DATE ENTERED APR 3 1979

CONTINUATION SHEET

ITEM NUMBER

PAGE

7

<u>ADDRESS/LOCATION</u>	<u>DATE BUILT</u>	<u>ARCHITECT</u>
115. 504 Dartmouth Street	1908	
116. 506 Dartmouth Street	1908	
117. 601 Dartmouth Street		
118. 602 Dartmouth Street		
119. 706 Dartmouth Street		
120. 707 Dartmouth Street		
121. 708 Dartmouth Street		
122. 807 Dartmouth Street	Pre 1908	
123. 903 Dartmouth Street		
124. 1002 Dartmouth Street		
125. 1004 Dartmouth Street		
126. 1300 Dartmouth Street		
127. 1301 Dartmouth Street		
128. 501 First Avenue		
129. 507-509 First Avenue		
130. 508 First Avenue		
131. 511 First Avenue		
132. 1107 First Avenue		
133. Old Brunswick Hospital 523 Norwich Street (west side of Norwich Street between First and Second Streets)		
134. 1612 Amherst Street		

GB

UNITED STATES DEPARTMENT OF THE INTERIOR
NATIONAL PARK SERVICE

FOR NPS USE ONLY	
RECEIVED	SEP 5 1978
DATE ENTERED	APR 3 1979

**NATIONAL REGISTER OF HISTORIC PLACES
INVENTORY -- NOMINATION FORM**

CONTINUATION SHEET

ITEM NUMBER

PAGE

8

ADDRESS/LOCATION

DATE BUILT

ARCHITECT

- 135. 1525-1527 Amherst Street
- 136. First African Baptist Church
(1400 block of Amherst Street,
east side)
- 137. 1417 Amherst Street
- 138. 1325 Amherst Street
- 139. 1321 Amherst Street
- 140. 1319 Amherst Street
- 141. 1317 Amherst Street
- 142. 1309 Amherst Street
- 143. 1307 Amherst Street
- 144. 720 Amherst Street
- 145. 700 Amherst Street
- 146. 1701 Wolf
- 147. 1626 Wolf
- 148. 913 Wolf
- 149. 719 Wolf
- 150. 601 Wolf
- 151. 1022 Carpenter Street
- 152. 1018 Carpenter Street
- 153. 1016 Carpenter Street
- 154. 1012 Carpenter Street

(64)

UNITED STATES DEPARTMENT OF THE INTERIOR
NATIONAL PARK SERVICE

**NATIONAL REGISTER OF HISTORIC PLACES
INVENTORY -- NOMINATION FORM**

FOR NPS USE ONLY
RECEIVED
SEP 5 1978
DATE ENTERED
APR 3 1979

CONTINUATION SHEET

ITEM NUMBER

PAGE

9

ADDRESS/LOCATION

DATE BUILT

ARCHITECT

155. 1010 Carpenter Street

156. 1008 Carpenter Street

157. 920 Carpenter Street

158. 918 Carpenter Street

159. 912 Carpenter Street

160. 908 Carpenter Street

161. 900 Carpenter Street

c. 1887

162. 814 Carpenter Street

163. 722 Carpenter Street

164. 718 Carpenter Street

165. 710 Carpenter Street

166. 708 Carpenter Street

167. 1611 Norwich Street

168. 1610 Norwich Street

169. 1608 Norwich Street

170. 1527 Norwich Street

171. 629 Norwich Street

172. Facing the Park, 600 block Norwich
Street (east side)

173. 1500 Albany Street

174. 1422 Albany Street

175. 1418 Albany Street

25

UNITED STATES DEPARTMENT OF THE INTERIOR
NATIONAL PARK SERVICE

**NATIONAL REGISTER OF HISTORIC PLACES
INVENTORY -- NOMINATION FORM**

FOR NPS USE ONLY	
RECEIVED	SEP 5 1978
DATE ENTERED	APR 3 1979

CONTINUATION SHEET

ITEM NUMBER

PAGE

10

<u>ADDRESS/LOCATION</u>	<u>DATE BUILT</u>	<u>ARCHITECT</u>
176. 1416 Albany Street		
177. 1412 Albany Street		
178. 1408 Albany Street		
179. 1017 Albany Street	Pre 1908	
180. 1013-1015 Albany Street	Pre 1908	
181. 1008 Albany Street		
182. 1007 Albany Street		
183. 1006 Albany Street		
184. 1005 Albany Street		
185. 1003 Albany Street		
186. 1001 Albany Street		
187. 828 Albany Street		
188. 825 Albany Street		
189. 815 Albany Street		
190. 812 Albany Street	Pre 1908	
191. 707-709 Albany Street		
192. 1527 Egmont Street		
193. 1525 Egmont Street		
194. 1417 Egmont Street		
195. 1123 Egmont Street		
196. 1121 Egmont Street		

26

UNITED STATES DEPARTMENT OF THE INTERIOR
NATIONAL PARK SERVICE

FOR NPS USE ONLY
RECEIVED SEP 5 1978
DATE ENTERED APR 3 1979

**NATIONAL REGISTER OF HISTORIC PLACES
INVENTORY -- NOMINATION FORM**

CONTINUATION SHEET

ITEM NUMBER

PAGE

11

<u>ADDRESS/LOCATION</u>	<u>DATE BUILT</u>	<u>ARCHITECT</u>
197. 1117 Egmont Street		
198. 1103 Egmont Street	Pre 1908	
199. 1027 Egmont Street	Pre 1908	
200. 1021 Egmont Street		
201. 1017 Egmont Street	Pre 1908	
202. 1009 Egmont Street	Pre 1908	
203. 1001 Egmont Street	Pre 1908	
204. 929 Egmont Street	Post 1908	
205. 919 Egmont Street		
206. 915 Egmont Street		
207. 913 Egmont Street		
208. 825 Egmont Street	Pre 1908	
209. 817 Egmont Street		
210. 729 Egmont Street		
211. 727 Egmont Street		
212. 723 Egmont Street		
213. 171 Egmont Street		
214. 713 Egmont Street		
215. 1716 Ellis Street		
216. 1712 Ellis Street		
217. 1706 Ellis Street		

UNITED STATES DEPARTMENT OF THE INTERIOR
NATIONAL PARK SERVICE

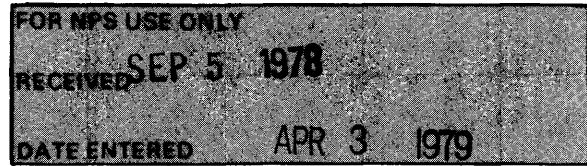

**NATIONAL REGISTER OF HISTORIC PLACES
INVENTORY -- NOMINATION FORM**

CONTINUATION SHEET

ITEM NUMBER

PAGE

12

<u>ADDRESS/LOCATION</u>	<u>DATE BUILT</u>	<u>ARCHITECT</u>
218. 1118 Ellis Street	Pre 1908	
219. 1120 Ellis Street	Pre 1980	
220. 1122 Ellis Street	Pre 1908	
221. 1628 Union Street		
222. 1624 Union Street		
223. 1618-20 Union Street		
224. 1616 Union Street		
225. 1617 Union Street		
226. 1610 Union Street		
227. 1327 Union Street	c. 1907	
228. 1315 Union Street		
229. 1322 Union Street		
230. 1303 Union Street	Pre 1885	
231. 1229 Union Street		
232. 1216 Union Street		
233. 1212 Union Street		
234. 1217 Union Street		
235. 1215 Union Street		
236. 1208 Union Street		
237. 1205 Union Street		
238. 1201 Union Street	1900-1915	

28

UNITED STATES DEPARTMENT OF THE INTERIOR
NATIONAL PARK SERVICE

**NATIONAL REGISTER OF HISTORIC PLACES
INVENTORY -- NOMINATION FORM**

FOR NPS USE ONLY
RECEIVED SEP 5 1978
DATE ENTERED APR 3 1979

CONTINUATION SHEET

ITEM NUMBER

PAGE

13

<u>ADDRESS/LOCATION</u>	<u>DATE BUILT</u>	<u>ARCHITECT</u>
239. 1200 Union Street		
240. 1128 Union Street	1893-1898	
241. 1127 Union Street		
242. 1120 Union Street	Post 1908	
243. 1114 Union Street		
244. 1112 Union Street	Pre 1893	
245. 1108 Union Street	1898-1908	
246. 1100 Union Street	Post 1908	
247. 1024 Union Street		
248. 1028 Union Street	Pre 1893	
249. 1027 Union Street		
250. 1014 Union Street	Pre 1898	
251. 1013 Union Street	1898-1908	
252. 1010 Union Street	1898-1908	
253. 1008 Union Street	1898-1908	
254. 1000 Union Street	1898-1908	
255. 928 Union Street	Pre 1898	
256. 927 Union Street		
257. 924 Union Street	Pre 1898	
258. 922 Union Street	Pre 1898	
259. 923 Union Street		

69

UNITED STATES DEPARTMENT OF THE INTERIOR
NATIONAL PARK SERVICE

**NATIONAL REGISTER OF HISTORIC PLACES
INVENTORY -- NOMINATION FORM**

FOR NPS USE ONLY	
RECEIVED	SEP 5 1978
DATE ENTERED	APR 3 1979

CONTINUATION SHEET

ITEM NUMBER

PAGE 14

<u>ADDRESS/LOCATION</u>	<u>DATE BUILT</u>	<u>ARCHITECT</u>
260. 908-910 Union Street	Pre 1908	
261. 905 Union Street		
262. 915 Union Street		
263. 911 Union Street		
264. 826 Union Street	Post 1908	
265. 827 Union Street	Pre 1908	
266. 821 Union Street		
267. 815 Union Street		
268. 811 Union Street	1872	
269. 801 Union Street	1917	
270. 818 Union Street		
271. 729 Union Street	Pre 1908	
272. 728 Union Street		
273. 720 Union Street	Pre 1908	
274. 716 Union Street	1884	
275. 721 Union Street	Pre 1908	
276. 711 Union Street		
277. 708 Union Street	Pre 1908	
278. 706 Union Street	Pre 1908	
279. 705 Union Street	Pre 1908	
280. 704 Union Street	Post 1908	

30

UNITED STATES DEPARTMENT OF THE INTERIOR
NATIONAL PARK SERVICE

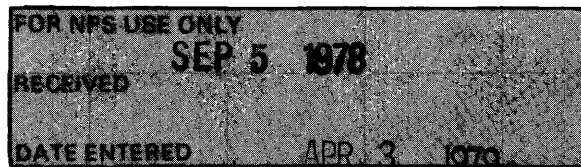

**NATIONAL REGISTER OF HISTORIC PLACES
INVENTORY -- NOMINATION FORM**

CONTINUATION SHEET

ITEM NUMBER

PAGE 15

<u>ADDRESS/LOCATION</u>	<u>DATE BUILT</u>	<u>ARCHITECT</u>
281. 703 Union Street	Pre 1908	
282. 628 Union Street		
283. 624 Union Street		
284. 615 Union Street		
285. 613 Union Street		
286. 608 Union Street		
287. 601 Union Street	Pre 1908	
288. 527 Union Street		
289. 528 Union Street		
290. 1715 Reynolds Street	Pre 1898	
291. 1711 Reynolds Street	Pre 1898	
292. Trendition House (1700 block of Reynolds Street, west side)	1891	
293. 1623 Reynolds Street		
294. 1621 Reynolds Street		
295. 1611 Reynolds Street		
296. 1609 Reynolds Street		
297. 1606 Reynolds Street		
298. 1529 Reynolds Street		
299. 1210-14 Reynolds Street		
300. 1202 Reynolds Street		

UNITED STATES DEPARTMENT OF THE INTERIOR
NATIONAL PARK SERVICE

**NATIONAL REGISTER OF HISTORIC PLACES
INVENTORY -- NOMINATION FORM**

FOR NPS USE ONLY	
RECEIVED	SEP 5 1978
DATE ENTERED	APR 3 1979

CONTINUATION SHEET

ITEM NUMBER

PAGE

16

<u>ADDRESS/LOCATION</u>	<u>DATE BUILT</u>	<u>ARCHITECT</u>
301. 1112 Richmond Street	Pre 1885	
302. 1108 Richmond Street	c. 1890	
303. 1018 Richmond Street	Pre 1885	
304. 1014 Richmond Street	Pre 1898	
305. 1012 Richmond Street	Post 1908	
306. 922 Richmond Street		
307. 914 Richmond Street		
308. 910 Richmond Street		
309. 908 Richmond Street		
310. 810 Richmond Street		
311. 808 Richmond Street		
312. 722 Richmond Street		
313. 720 Richmond Street		
314. 708 Richmond Street		
315. 1426 New Castle Street		
316. 1420 New Castle Street		
317. 1423 New Castle Street	1892	
318. 1419 New Castle Street		
319. 1401 New Castle Street		
320. Old City Hall (north end of block bounded by Mansfield, New Castle, Howe and Grant Streets)	1889	A.S. Eichberg

30

UNITED STATES DEPARTMENT OF THE INTERIOR
NATIONAL PARK SERVICE

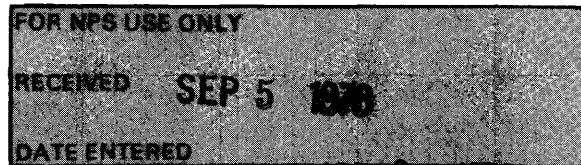

**NATIONAL REGISTER OF HISTORIC PLACES
INVENTORY -- NOMINATION FORM**

3 1979

CONTINUATION SHEET

ITEM NUMBER

PAGE 17

<u>ADDRESS/LOCATION</u>	<u>DATE BUILT</u>	<u>ARCHITECT</u>
321. 1330 New Castle Street		
322. 1327-31 New Castle Street	1885	
323. 1312-1320 New Castle Street	1890	
324. 1311-13 New Castle Street		
325. 913 New Castle Street		
326. 701 New Castle Street		
327. 520 New Castle Street		
328. 1525 Grant Street		
329. 1117 Grant Street	Post 1908	
330. 1113 Grant Street	Post 1908	
331. 1021 Grant Street	Pre 1898	
332. 1015 Grant Street	Pre 1898	
333. 1011 Grant Street	Pre 1898	
334. 779 Grant Street		
335. 725 Grant Street		
336. 721 Grant Street		
337. 1002 Oglethorpe Street		
338. 725 Oglethorpe Street		
339. 729 Oglethorpe Street		
340. Second Advent Christian Church (H Street, north side, between Union and Ellis Streets)	c. 1903	

UNITED STATES DEPARTMENT OF THE INTERIOR
NATIONAL PARK SERVICE

**NATIONAL REGISTER OF HISTORIC PLACES
INVENTORY -- NOMINATION FORM**

FOR NPS USE ONLY	
RECEIVED	SEP 5 1978
DATE ENTERED	APR 3 1979

CONTINUATION SHEET

ITEM NUMBER

PAGE

18

<u>ADDRESS/LOCATION</u>	<u>DATE BUILT</u>	<u>ARCHITECT</u>
341. Halifax Square (south, bounded by Egmont and Norwich Streets)	Pre 1908	
342. 9 Halifax Square	Pre 1908	
343. 8 Halifax Square	Pre 1908	
344. 3 Halifax Square	Pre 1908	
345. 2 Wright Square	Pre 1908	
346. Northeast corner of Egmont and London (no street address available)		

UNITED STATES DEPARTMENT OF THE INTERIOR
NATIONAL PARK SERVICE

FOR NPS USE ONLY

RECEIVED SEP 5 1978

DATE ENTERED APR 3 1979

**NATIONAL REGISTER OF HISTORIC PLACES
INVENTORY -- NOMINATION FORM**

CONTINUATION SHEET

ITEM NUMBER

PAGE

Item #9, Page 2

Major Bibliographical References:

Newspapers on Microfilm, Brunswick Public Library, Brunswick Junior College Library
Brunswick City Directories, Brunswick Public Library

Item #10, Page 2

Verbal Boundary Description:

Second Advent Christian Church on the north side of H Street between Union and Ellis Streets, adjacent to the aforementioned north boundary; as shown on the accompanying maps.

UNITED STATES DEPARTMENT OF THE INTERIOR
NATIONAL PARK SERVICE

**NATIONAL REGISTER OF HISTORIC PLACES
INVENTORY -- NOMINATION FORM**

FOR NPS USE ONLY	
RECEIVED	SEP 5 1978
DATE ENTERED	ADD. 2 1070

CONTINUATION SHEET

ITEM NUMBER

PAGE

OLD TOWN BRUNSWICK, BRUNSWICK, GLYNN COUNTY
List of Intrusions (1927-1977) and Their General Location
(These numbers correspond to those on the sketch map.)

- | | |
|-----------------------------------|---|
| 1. Brunswick Housing Authority | East side of Albany Street between George and Mansfield Streets |
| 2. Glynnville Apartments | East side of Albany Street between George and Mansfield Streets |
| 3. Small Store and Coin Laundry | Northeast corner of Albany and Mansfield Streets |
| 4. Piddlers Antique Shop | West side of Cochran between Gloucester and F Streets |
| 5. Arrow Cleaners | West side of Cochran between Gloucester and F Streets |
| 6. Service Station | North side of Gloucester Street between Amherst and Cochran Streets |
| 7. Service Station | North side of Gloucester Street between Norwich and Egmont Streets |
| 8. Service Station | South side of Gloucester Street between Wolf and Carpenter Streets |
| 9. Glynn Academy Science Building | South side of Monck Street between Egmont and Albany Streets |
| 10. Sidney Lanier School | South side of Mansfield Street between Egmont and Albany Streets |
| 11. Glynn County Middle School | North side of George Street between Egmont and Albany Streets |
| 12. Small Store | South side of First Street between Norwich and Wolf Streets |

UNITED STATES DEPARTMENT OF THE INTERIOR
NATIONAL PARK SERVICE

**NATIONAL REGISTER OF HISTORIC PLACES
INVENTORY -- NOMINATION FORM**

FOR NPS USE ONLY	
RECEIVED	SEP 5 1978
DATE ENTERED	ADD 3 1070

CONTINUATION SHEET Intrusions ITEM NUMBER PAGE 2

- | | | |
|-----|---------------------------------|---|
| 13. | Radio Station | North side of Mansfield Street between Ellis and Egmont Streets |
| 14. | Glynn County Board of Education | West side of Egmont Street between Mansfield and Monck Streets |
| 15. | U. S. Post Office | North side of Gloucester Street between Ellis and Egmont Streets |
| 16. | First Federal Building | North side of Gloucester Street between Ellis and Union Streets |
| 17. | Service Station | Southeast corner of Gloucester and Union Streets |
| 18. | American National Drive-In Bank | Northeast corner of Monck and Union Streets |
| 19. | Department of Labor | West side of Union Street between Monck and Mansfield Streets |
| 20. | St. Francis Xavier School | West side of Union Street between Howe and George Streets |
| 21. | Service Station | Southeast corner of Gloucester and Reynolds Streets |
| 22. | Glynn County Health Department | North side of Mansfield Street between Richmond and Reynolds Streets |
| 23. | St. Francis Xavier Church | Northeast corner of New Castle Street at Hanover Square |
| 24. | Glynn County Library | South side of Gloucester Street between New Bay and Grant Streets |
| 25. | Coastal Bank of Georgia | North side of Gloucester Street between New Castle and Richmond Streets |

(15)

UNITED STATES DEPARTMENT OF THE INTERIOR
NATIONAL PARK SERVICE

**NATIONAL REGISTER OF HISTORIC PLACES
INVENTORY -- NOMINATION FORM**

FOR NPS USE ONLY	
RECEIVED	SEP 5 1978
DATE ENTERED	APR 3 1979

CONTINUATION SHEET Intrusions ITEM NUMBER PAGE 3

- | | | |
|-----|--|--|
| 26. | Coastal Bank of Georgia Drive-In | West side of Reynolds Street between F and Gloucester Streets |
| 27. | Georgia Power Company | South side of Gloucester Street between Ellis and Egmont Streets |
| 28. | Penny's | Northwest corner of New Castle and F Streets |
| 29. | Gateway Building
(Old Holiday Inn) | Southwest corner of New Castle and G Streets |
| 30. | Service Station | Southeast corner of New Castle and G Streets |
| 31. | Hayes Building | North side of G Street between New Castle and Reynolds Streets |
| 32. | Glynn County Detention Center | East side of New Castle Street between G and H Streets |
| 33. | Brunswick Police Department | South side of Mansfield Street between New Bay and Grant Streets |
| 34. | East Coast Glass Company | East side of Bay Street between Albermarle and Dartmouth Streets |
| 35. | Texaco, Inc. (plant) | West side of Bay Street between London and George Streets |
| 36. | Gulf Oil Company | West side of Bay Street between London and George Streets |
| 37. | Atlas Signs | East side of Oglethorpe Street between First and Dartmouth Streets |
| 38. | Glynn County Veterinary Hospital, Inc. | West side of Grant Street between Howe and Mansfield Streets |

16

PROPERTY OWNERS WITHIN BRUNSWICK OLD TOWN HISTORIC DISTRICT - SUPPLEMENTAL LIST TO MAIN LIST EXTRACTED FROM COMPUTER TAX RECORDS

A. W. Gragg
P. O. Box 1652
Brunswick, Georgia 31520

Frank Garrison King
Mary L. King
528 Union Street
Brunswick, Ga. 31520

James R. Tuten, Jr.
Myrta C. Tuten
1000 Egmont Street
Brunswick, Georgia 31520

Southside Baptist Church
Brunswick, Georgia 31520

Dennis VanDora
P. O. Box 1574
Brunswick, Georgia 31520

Charles A. Mills
527 Union Street
Brunswick, Georgia 31520

Charles C. Drawdy
508 1st Avenue
Brunswick, Georgia 31520

Glynn Distributors, Inc.
P. O. Drawer E
Brunswick, Georgia 31520

Henry David Lancaster
P. O. Box 1527
Brunswick, Georgia 31520

B. B. and Lucille Paulk
801 Albany Street
Brunswick, Georgia 31520

Eleanor J. Brown
805 Albany Street
Brunswick, Georgia 31520

Estate of George H. Cook, Jr.
c/o Mrs. Mary C. Cook, Executrix
1001 Carpenter Street
Brunswick, Georgia 31520

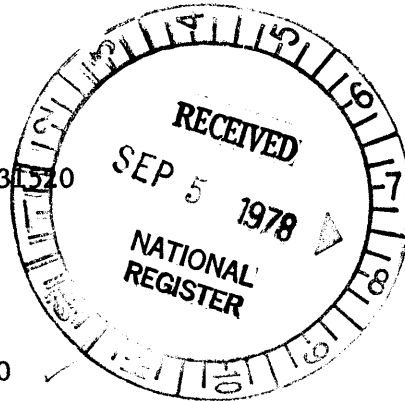

William Harrison, Jr.
1129 Lanier Blvd.
Brunswick, Georgia 31520

Brian and Susan Berrie
825 Albany Street
Brunswick, Georgia 31520

Ernest L. Craft
Box 383
Warm Springs Hospital
Warm Springs, Georgia 31830

Hazel H. Harrison
1129 Lanier Blvd.
Brunswick, Georgia 31520

Alla Mae Brown
Eleanor Brown
Phyllis Brown
805 Albany Street
Brunswick, Georgia 31520

Mrs. Sara Pyron Chastain
800 Albany Street
Brunswick, Georgia 31520

Edward B. Parker
C/o Parker Realty
Brunswick, Georgia 31520

P. F. and Lois Gould
P. O. Box 73
Brunswick, Georgia 31520

David Merier
The Piddlers
1505 Cochran Avenue
Brunswick, Georgia 31520

Ruby Mapp Cook
820 Albany Street
Brunswick, Georgia 31520

Marjorie C. Beals Lancaster
822 Albany Street
Brunswick, Georgia 31520

199
APR 3 1979

Mrs. Willie Cunningham
828 Albany Street
Brunswick, Georgia 31520

J. C. Kaufman
c/o Parker Realty Co.
Brunswick, Georgia 31520

Arthur and Sybil Moses
824 Amherst Street
Brunswick, Georgia 31520

Saul A. Alvin
1203 I Street
Brunswick, Georgia 31520

Anderson Meridy
913 Cochran Avenue
Brunswick, Georgia 31520

Gladys Cummings and Louise F. Cummings
812 Amherst Street
Brunswick, Georgia 31520

Andrew Phillips
3415 Laren Lane, S. W.
Atlanta, Georgia

Esate J. R. Tuten
C/o Parker Realty
Brunswick, Georgia 31520

Katie Wilson
C/o Parker Realty
Brunswick, Georgia 31520

James A. Stephens
2417 Johnson Street
Brunswick, Georgia 31520

Henry J. Smith
1524 Albany Street
Brunswick, Georgia 31520

Isaac and Wilhelmina Robinson
811 Cochran Avenue
Brunswick, Georgia 31520

George Davis
819 Cochran Avenue
Brunswick, Georgia 31520

Mabel Moses
821 Cochran Avenue
Brunswick, Georgia 31520

Carlton and Marie M. Johnson
1102 Dartmouth Street
Brunswick, Ga. 31520

Louise B. Evans
716 Amherst Street
Brunswick, Ga. 31520

Davis Brown
P. O. Box 8
Brunswick, Ga. 31520

Marie Douglas
1412 Albemarle
Brunswick, Ga. 31520

J. W. Leigh and M. C. Leigh
1400 Albemarle Street
Brunswick, Ga. 31520

A. V. Grantham
P. O. Box 542
Brunswick, Georgia 31520

Gladstone Brown
P. O. Box 1639
Brunswick, Ga. 31520

Jadine Higginbotham
144 Dees Drive
Brunswick, Ga. 31520

Harold Cann and Mildred Cann
1310 Albemarle Street
Brunswick, Ga. 31520

S. J. and Ione Parsons
Rt. 5, Box 30
Brunswick, Georgia 31520

E. G. Lambricht
1301 Dartmouth Street
Brunswick, Georgia 31520

Al Chapman
P. O. Box 1511
Brunswick, Georgia 31520

Mrs. Courtney Allen Gay
726 Albany Street
Brunswick, Georgia 31520

Rex Thompson
1215 Dartmouth Street
Brunswick, Georgia 31520

210

Lillie Mae Harper Sandifer
711 Albany Street
Brunswick, Georgia 31520

Fletcher Holmes, Sr.
713 Albany Street
Brunswick, Georgia 31520

Keith Brown
1411 London Street
Brunswick, Georgia 31520

R. L. Spaulding, Jr.
RFD 1, Box 67
Brunswick, Georgia 31520

Edward W. Latham
716 Albany Street
Brunswick, Georgia 31520

Peggy Ann Bearden
C/o First Federal Savings and Loan
Brunswick, Georgia 31520

Roger A. & Montez J. Parsons
613 Albany Street
Brunswick, Georgia 31520

Mrs. W. T. Meeks
C/o Alynne M. Branson
627 Albany Street
Brunswick, Georgia 31520

Eugene R. Branson
625 Albany Street
Brunswick, Georgia 31520

James O. Taylor
1311 1st Avenue
Brunswick, Georgia 31520

Robert L. McAlum
608 Albany Street
Brunswick, Georgia 31520

Joann Schreibner
3540 North Shore Drive
Columbia, S. C.

J. H. Tyre
1310 Dartmouth
Brunswick, Georgia 31520

Mrs. Mallye O. Taylor
502 Wesley Circle
St. Simons Island, Georgia 31520

William Roae
1307 1st Avenue
Brunswick, Georgia 31520

Charles H. Farrar
1407 Dartmouth Street
Brunswick, Georgia 31520

Mrs. J. O. Deaver
1311 Dartmouth Street
Brunswick, Georgia 31520

Marguerite Helms Zell
708 Albany Street
Brunswick, Georgia 31520

R. Gladstone Brown
P. O. Box 1639
Brunswick, Georgia 31520

J. W. & Omie B. McKinney
716 Wolfe Street
Brunswick, Georgia 31520

William & Annie C. Dean
708 Wolfe Street
Brunswick, Georgia 31520

George S. Frederick
1201 Dartmouth Street
Brunswick, Georgia 31520

Howard B. Haisten
2232 Ocean Road
East Beach, St. Simon's Island
Georgia 31522

J. R. Callahan
1200 Dartmouth Street
Brunswick, Georgia 31520

Malcolm C. Hatcher
623 Albany Street
Brunswick, Georgia 31520

Pauline B. Leavy
621 Albany Street
Brunswick, Georgia 31520

Rot A. Soper
2102 Cairmont Lane
Brunswick, Georgia 31520

P. R. Frauss
317 Norwich Street
Brunswick, Georgia 31520

H. C. Shurling
601 Albany Street
Brunswick, Georgia 31520

501

All addresses are Brunswick 31520 unless otherwise noted:

Mrs. Marguerite Meagher
600 Albany Street

Herman E. Yawn
620 Albany

Victor Schreiber
P. O. Box 820

Nora McPowell
603 Cochran Avenue

G. H. Leggett, Sr.
606 Amherst Street

Doris Daniels
615 Cochran Avenue

Raymond D. Queen
627 Cochran Avenue

Carlton Johnson
1102 ~~PARMOUTH~~

Dorris Smith
P. O. Box 1142

Robert Cook
622 Amherst Street

Herman Spencer
602 Amherst Street

Wilbur Clark
1004 Albany Street

Eva T. Friedman
2919 Wildwood Drive

Margaret Florence
1017 Cochran Avenue

Miss Mary E. Miller
P. O. Box 1177

Al Lindsay
1400 George Street

Charlie Shed
1306 George Street

Mrs. R. C. Lindsay
1400 George

Fannie N. Phillips Kinstle
1123 Magnolia Avenue

Priscilla H. Deveaux
913 Amherst Street

J. M. McMillan
6 Gould Lane
Jekyll Island, Georgia 31520

Mary E. Miller
P. O. Box 1177

Dorothy Barnamon
2426 Gordon Street

Marie N. Hughes
900 Carpenter Street

Margaret and Robert Florence
1017 Cochran Avenue

Saint Andrews Holiness Church
1006 Amherst Street

Keith L. and Lila S. Brown
1411 London Street

Georgia Power Company
P. O. Box 4549
Atlanta, Georgia

Helen D. Hill
1017 Cochran Avenue

Lillie Florence
1017 Cochran Avenue

Mrs. Ida R. Lockwood
721 Union Street

Lucill Atkinson
1524 Albany Street

James and Lizzie Mosley
922 Amherst Street

Ella Kelly
918 Amherst Street

Suzie and Albert Gordon
913 Cochran Avenue

507

All addresses Brunswick, Georgia 31520 unless otherwise noted

Mirdis Ashley
1401 Prince Street

Marie J. Cofer
4340 E. 15th Street
St. Simon's Island, Georgia 31520

Louise P. Ellington
922 Albany Street

Walter McNeely
2001 Starling Street

Charles V. Liphtratt
Rt. 1, Box 83
Satilla Shores
Brunswick, Georgia 31520

Charlie Mae Redding
912 Albany Street

Viola Hazzard
908 Albany Street

Robert Ruff
1303 Prince Street

John A. Kaufman
C/o Parker Realty

Anna Mann
910 Amherst Street

Charles Jones
908 Amherst Street

Macon Gideon Trust
C/o A. J. Wood, Trustee
4911 River Point Road
Jacksonville, Florida 32207

City of Brunswick
P. O. Box 550

Almeda Bryant Stevens
C/o Parker Realty

Susie and Albert Jordan
913 Cochran Avenue

Melvina Harris
921 Cochran Avenue

John Parrish
915 Amherst Street

Irene Noble
917 Amherst Street

Matilda Cooper
921 Amherst Street

James Noble
905 Amherst Street

Estella Banks
1307 Prince Street

Sennie Lewis
1305 Prince Street

Ida Mae Smith
Iona Atwaters Smith
911 Amherst Street

William Sullins
1300 Gloucester Street

William G. Baker
C/o Harriette Smith
1422 Albany Street

Loretta Pery and Willie Perry
1420 Albany Street

Florida Stockton
1412½ Albany Street

Eulalia Wilson
2719 Albany Street

Drusilla Roland
1406 Albany Street

Miss Ann Shellman
1404 Albany Street

all address are Brunswick 31520 unless otherwise noted

Mrs. Nan Herring 1620 Kay Avenue ✓	Henry Shaw ✓ 1411 Cochran Avenue
Roy Rivers ✓ 1305 Monk Street	Laura Clark ✓ 1413 Cochran Avenue
Lula Buggs ✓ 1405 Amherst Street	Edgar R. Mock, Jr. ✓ 517 Albany Street
Clifton Tyson ✓ 1411 Amherst Street	Catherine Mills ✓ 1413 Amherst Street
Prudence and Theresa Hall ✓ 2015 Albany Street	Willie E. Stephens ✓ 1158 Demere Road St. Simon's Island, Georgia 31522
Pearl Roberts Chapple ✓ 1421 Amherst Street	Edith Smith ✓ 1322 Amherst Street
Walter Gibson ✓ C/o Parker Realty	T. C. Early ✓ 1312 Monck Street
Samuel Denegal ✓ 2311 Albany Street	Louise Easton ✓ c/o Edward L. Easton 197 Chadwick Avenue Newark, N. J.
Mamie Patterson ✓ 1409 Mansfield Street	Malvina C. Glover ✓ 1315 Cochran Avenue
Ellen M. Wilson ✓ 1308 Amherst Street	Efthymios P. Kalcos ✓ 101 Glynwood Drive
Josephine McIver ✓ 1312 Amherst Street	Mrs. Lee G. Gross ✓ P. O. Box 226 Lenox, Georgia
Albert S. Brown ✓ 231 Magnolia Avenue St. Simons Island, Georgia 31522	Joseph W. Patterson ✓ 3875 Bakers Ferry Road, S. W. Atlanta, Georgia 30331
First African Baptist Church ✓	Ella Atkinson ✓ 1000 Cochran Avenue
Harold R. Buckley ✓ 1410 Amherst Street	J. E. Youmans ✓ 1328 Albany Street
Rachel Brown ✓ 1406 Amherst Street	Brooks Building Inc. ✓ P. O. Box 610 Douglas, Georgia
Ophelia Holmes ✓ 1404 Amherst Street	Harold Tatnall ✓ 1600 London Street
Corner stone # 8 F & AM Lodge ✓ c/o Taylor Harris 1824 Wolfe Street	
Albert Shelander ✓ P. O. Box 40	
Roy L. Smith ✓ 1503 Gloucester	

All address Brunswick, Georgia 31520 unless otherwise noted

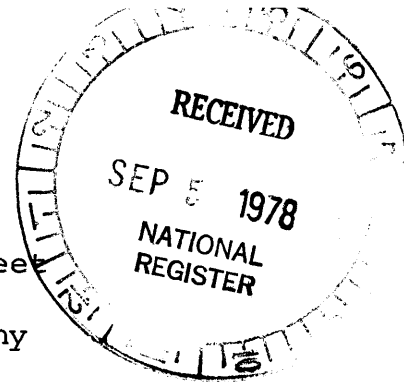

Hazel Tatnall Pierce ✓
358 Treadwell Street
Orangeburg, South Carolina

Lewis Alexander ✓
C/o Lewis Alexander, Jr.
1320 N. Wanamaker Street
Philadelphia, Penn. 19131

Lula Bell Howard Freeman ✓
1306 Albany Street

Carley Zell ✓
P. O. Box 1239

Lillian Walker ✓
1307 Mansfield Street

Benjamin Jaudon ✓
1311 Mansfield Street

Ethel Jackson ✓
C/o Ralph Jackson
1107 Monck Street

Aaron Walker ✓
1325 Amherst Street

Mary Early ✓
1312 Monck Street

R. E. Hood ✓
1904 Elm Avenue

Carrie Sheffield ✓
c/o Robert Llord, Jr.
1507 Amherst Street

Est. of Jamie Dobeacle ✓
C/o John Gilbert - Executpr
P. O. Box 190

American National Bank ✓
Selma F. Shelander
P. O. Box 1398

Arnetta Jackson ✓
1506 Albany Street

Shell Oil Company ✓
P. O. Box 2099
Houston, Tx. 77001

Daniels Moses Sons Inc. ✓
1521 Cochran Avenue

Hershel Mauldin ✓
1527 Cochran Street

Cornelius Vanderbilt Troup, Sr. ✓
1499 Mill Acres Drive, S. W.
Atlanta, Georgia 30311

Celia Williams ✓
1716 Albany Street

Lillian Collins ✓
1720 Amherst Street

Willie Nelson ✓
1714 Amherst Street

Hortense Sapp ✓
C/o Parker Realty

Curtis Castellio ✓
1411 L Street
St. Simons Island, Georgia 31522

Maney Twyne ✓
Twyne's Barber Shop
1613½ Albany Street

Callin Atkinson ✓
1508 Amherst Street

Lola Callin Reinsch ✓
4525 N. 35th Street
Arlington, Virginia 22207

Willie Moore ✓
1327 Lee Street

205

All addresses are Brunswick unless otherwise noted

Typed ✓
Helen M. Simmons
1626 Amherst Street ✓

George Mae West
1708½ Gordon Street ✓

Hazel Atkinson
1601 Amherst Street ✓

Stelman Simmons
1615 Cochran Avenue ✓

Leroy Gibson
c/o Mrs. Ruth Logan
120 McIntyre Court ✓

Edna Lee Johnson
1619 Cochran Avenue ✓

Peter Bacon
1621 Cochran Avenue ✓

Richard Lee Shavers
1623 Cochran Avenue ✓

willie Lewis
3005 Albany Street ✓

Willie Simmons, III
2410 J. Street ✓

Odd Fellow Lodge
c/o Ralph Jackson
1107 Monck Street ✓

Abraham Smith
1008 Johnson Street ✓

C. P. Langford, Jr.
518 Old Mission Road ✓

B. M. Edwards Estate
c/o Parker Realty ✓

Rosa Tucker
1620 Amherst Street ✓

Helen Davis
1614 Amherst Street ✓

Bernice B. Palmer
1205 T. Street ✓

W. P. Holmes
P. O. Box 249 ✓

James and Anna Robinson
1609 Cochran Avenue ✓

Charles and Geraldine Williams
1706 Albany Street ✓

E. C. Tillman
1910 Kay Avenue ✓

Mattie and Homer Lee Knight
1307½ G Street ✓

Georgia Mae Price
1711 Lee Street ✓

Estate of Albert Wilson
c/o Mary Lee Wilson
Rt. 4. Box 376
St. Simon's Island, Georgia 31522 ✓

Levern Carter
3302 Franklin Avenue ✓

Ida Mae Elkins
1711 Amherst Street ✓

Mattie Powell
1713 Amherst Street ✓

606

all addresses Brunswick 31520 unless otherwise noted

Cephus Walker
1715 Amherst Street

Willie Mae Magwood
1721 Amherst Street

Eugene and Gloris Grant
1723 Amherst Street

Leroy and Pearlie Mae Simpkins
1708 Albany Street

Bessie Lee Duncan
1710 Albany Street

Lucy Floyd
C/o Thomas Floyd
416 12th Street
St. Si on's Island, Georgia 31522

Violet Burroughs
1611 Amherst Street

E. H. Battle
1613 Amherst Street

Mattie Knight
1615 Amherst Street

Everlina Jenkins
1621 Amherst Street

Lester Green
1310 G Street

Heirs Tressie Johnson
1308 G Street

Ruth Fahm
1522 Albany Street

Henry Sams, Jr.
3512 Franklin Avenue

Bertha Mae Paul
2109 Albany Street

S

Mabel Green
1512 Albany Street

Nelson T. Holloway
1811 Ellis Street

Leola Dukes
1513 Amherst Street

Lillie B. Williams
1515 Amherst Street

Ilea Anderson
1521 Amherst Street

William M. Boden
1523 Amherst Street

Martha A. Stewart
C/o American National Bank Trust

Pride of Brunswick Lodge # 745
c/o T. D. Pikens
3100 Brailsford Avenue

Willodeen Williams James
1522 Amherst Street

Mary Mungin
1514 Amherst Street

Ruby and Dave Monroe
Rt 6 Box 254

Pricilla Massey
1810 O Street

Sallie Jackson
C/o Ellen Dennis
1306 H Street

Mabel W. Cassells
1700 Wolfe Street

Jennie Sykes Ray
2105 Stonwall Street

Daniel and Minniola Berry
1718 Albany Street

207

Thomas P. and Birdie Williams
1716 Albany Street

~~XXXXXXXXXXXX~~ ✓
~~XXXXXXXXXXXX~~

Redessa Barneman
Mallie Barneman
1727 Amherst Street ✓

Alberta Mills ✓
1305 G Street

Stephen R. Been ✓
6122 Altama Avenue

Etta Pyles ✓
1507 Albany Street

Charles H. Anthony ✓
3905 S. E. 25th Street
Topeka, Ka. 66605

214

DERIVATIVES OF THE SAVANNAH PLAN

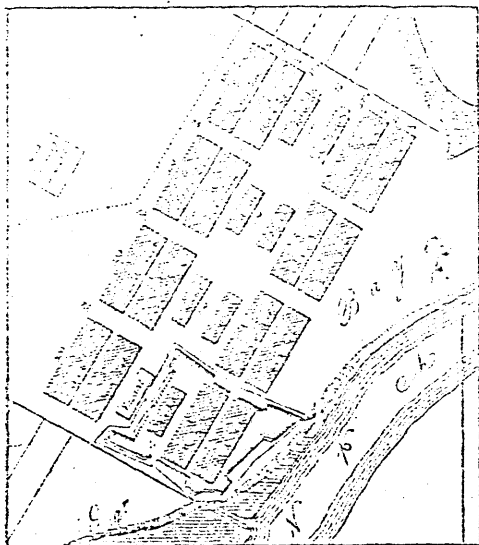

Ebenezer, 1733

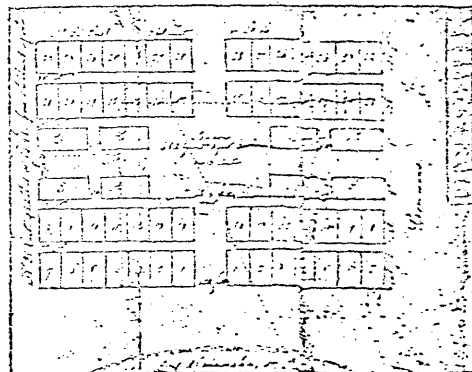

Darien

