

**HOWARD COFFIN PARK
PLAYGROUND STRUCTURE**

Addendum #1

July 12, 2019

- I.** All playground equipment must conform to current ASTM and ADA requirements.
- II.** All playground equipment shall be IPEMA (International Play Equipment Manufacturers Association) certified.
- III.** Installation of playground equipment must be performed by a NPSI (National Playground Safety Institute) certified playground installer.

Questions and Answers:

1. Where is the proposed playground to be located at Howard Coffin Park?

On the north side of the existing tennis courts --See Attached site plan

2. What are the dimensions of the proposed playground area?

As shown on the site plan, there is an area up to 80' x 140' is available for the proposed playground

3. Will any site preparation or grading of the site be required?

All site preparation and grading will be completed by the City of Brunswick Public Works Department.

4. Is drainage a concern for the location?

Any drainage improvements at the site will be completed by the City of Brunswick Public Works Department.

5. Is there a budget for the project?

The tentative project budget is \$150,000

6. Is the project tax exempt?

Yes. The City's tax exemption form can be provided if necessary.

7. Will permitting be required?

No permitting will be required for this project.

8. Will engineering drawings be required for the project?

Stamped engineering drawings are not required for the project. Certifications and conformity to industry standards must be provided as stated above.

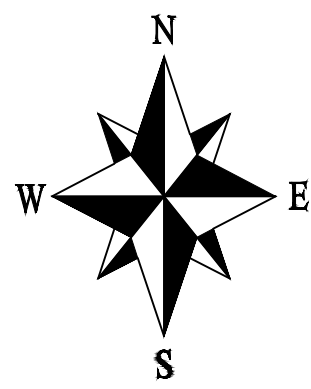

- LEGEND**
- WOOD POST
 - PARK BENCH
 - WATER VALVE
 - STEEL LIGHT POLE
 - FIRE HYDRANT
 - UTILITY POLE WITH LIGHTS
 - TELEPHONE BOX
 - BICYCLE RACK
 - TANK
 - TRASH BIN
 - WATER FAUCET
 - GAS VALVE
 - ELECTRIC METER
 - LAUNCH DECK
 - GUIDE WIRE
 - BBO GRILL

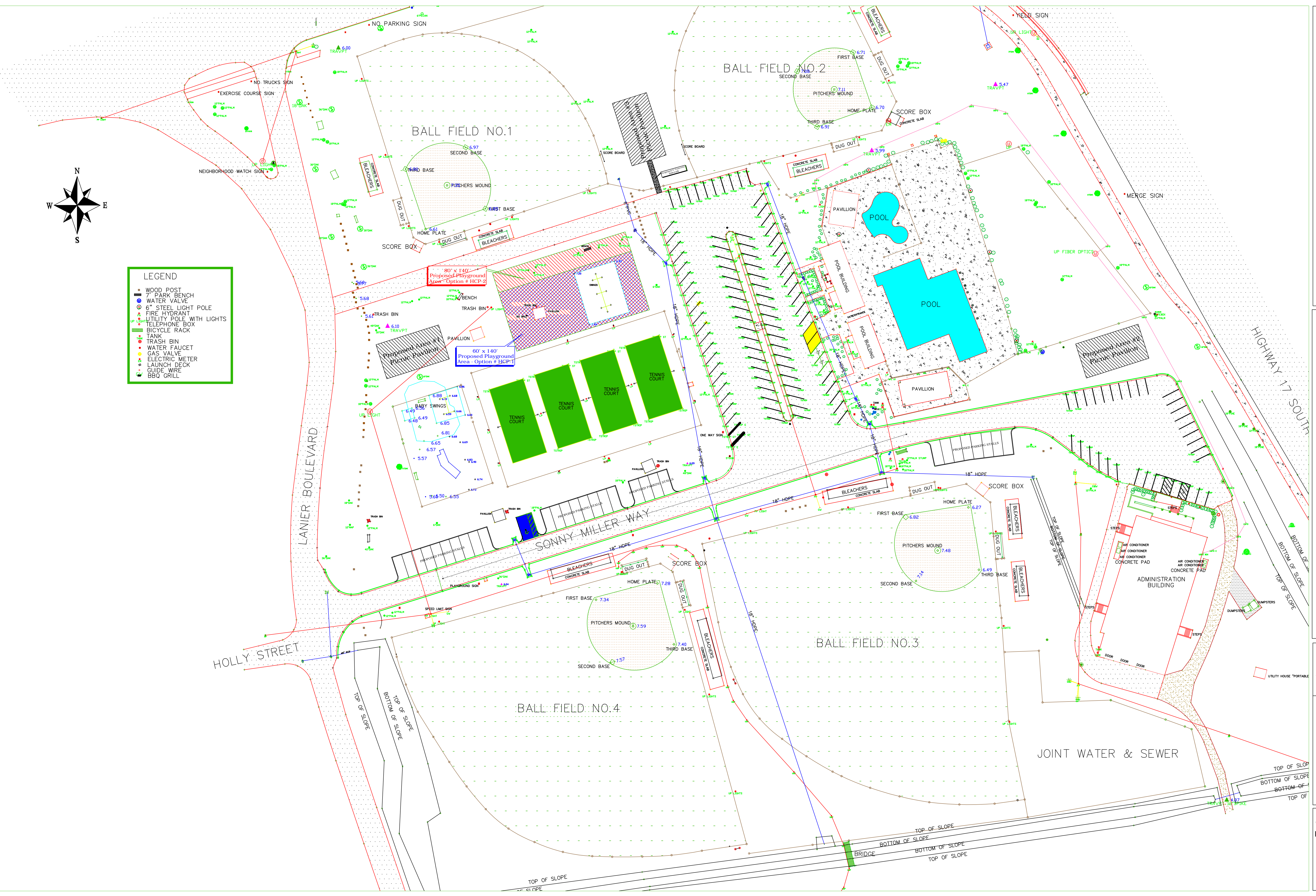

Operated by:
Glynn County Recreation & Parks Department
 Dept. Director: John Powell
 Dept. Manager: Mead Herndon

PROPOSED SPLIT 6 PARK IMPROVEMENTS
 Howard Coffin Park
 1402 Sonny Miller Way
 Brunswick, Georgia 31520
 (912) 279-3810

REVISIONS	DATE

Sheet
1 of 2